

Polycarbonate Enclosure Cord Grip Installation

- 1) Tools required: Drill, Step drill bit or 13/16" hole saw



- 2) Locate the position where the cord is going to be installed. Check the inside of the enclosure to make sure there is not a rib or other formed feature on the inside of the enclosure that would prevent the cord grip from seating properly.
- 3) Do not use a standard 13/16" drill bit as the flute is too large and will cause a large burr and cause damage to the enclosure. 1/4" pilot drill bit works fine if needed. **Clean chips from inside of enclosure.**



- 4) Install cord grip
- a. SKU 351192 Cord Grip for cables that do not have connectors. Follow steps below.

- Steps:**
- 1) Run cable without connector thru seal
 - 2) Add RJ 45 connector to cable
 - 3) Tighten cinch nut

- b. SKU 576422 Cord Grip for RJ45 cables that have connectors. Follow steps below.

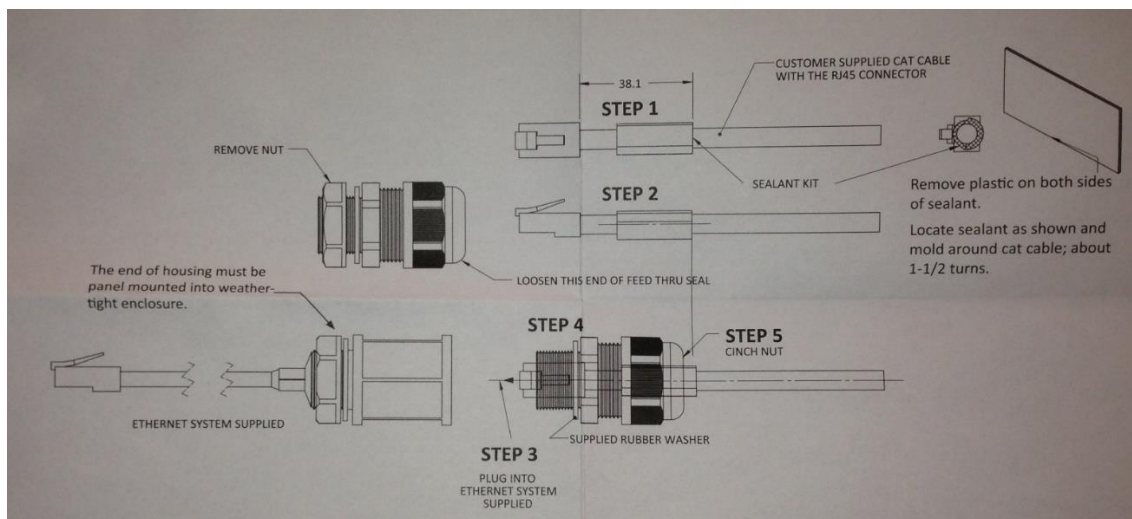

- Steps:**
- 1) Apply sealant
 - 2) Slide cable thru fitting
 - 3) Mate plug and jack inside ethernet system
 - 4) Fully seat supplied feed thru to ethernet system
 - 5) Tighten cinch nut only if sealant is in proper location